

FLOOR PLAN FORM

Site No.: HBRf 39

39

1. Excavation Unit: 20 / 23

2. Level Nos.: 7 - ~~23~~ 23

3. Excavators: GMS

4. Comments:

(N24, E20) (N24, E21)

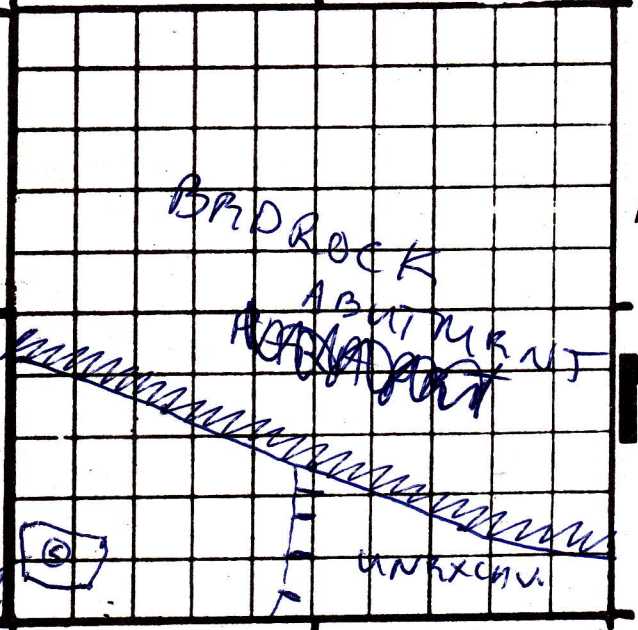

(N23, E20) (N23, E21)

Level No.: 7 - ~~23~~ 23

UNIT 23
(N23, E20) (N23, E21)

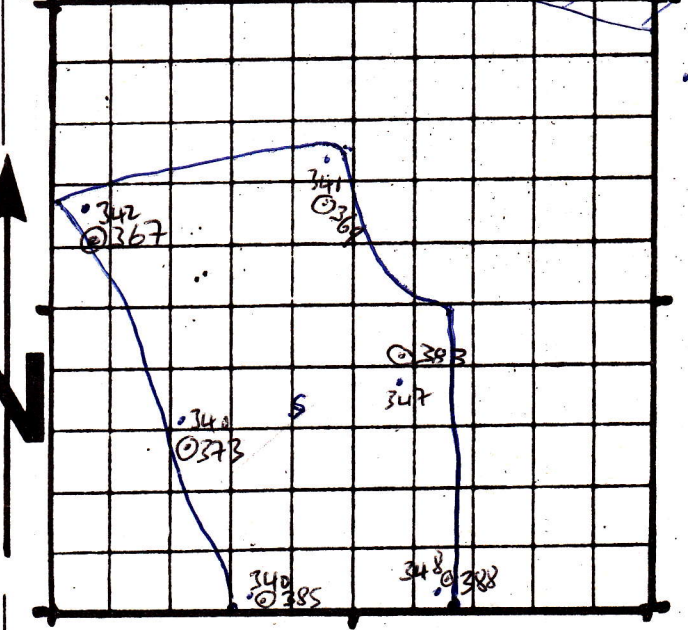

(N22, E20) (N22, E21)

Level No.: 98-1

(,) (,)

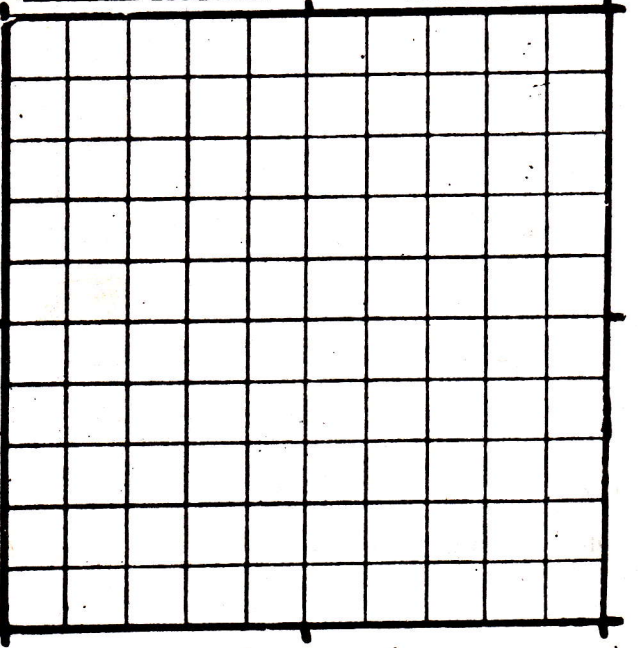

Level No.: _____

(,) (,)

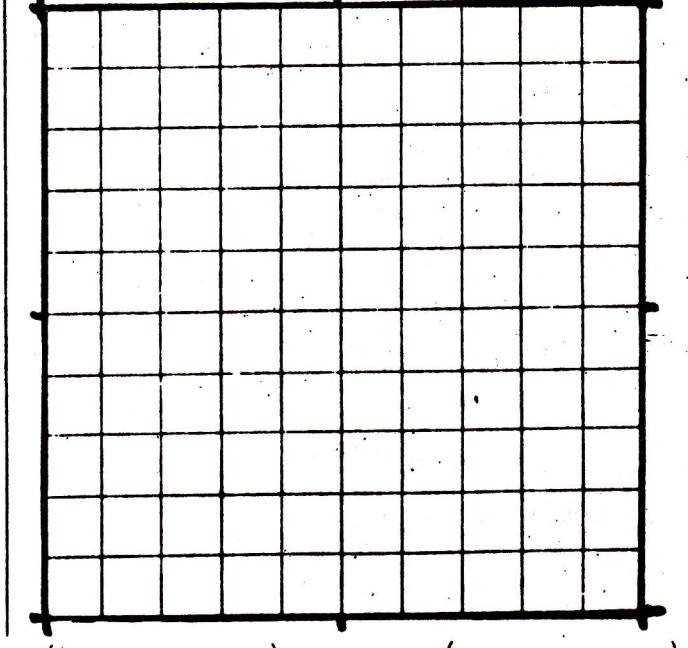

Level No.: _____

I = 10 cm.

UNIT 20
228
105
3
321 TOP
DBO TOP 2
221
DBO BOTTOM
333
ON SLOPE
DOWN TO E.

#22

1. Excavation Unit: N 23 24 E 22-23

2. Level Nos.: 23-1

3. Excavators: HANDLY

4. Comments:

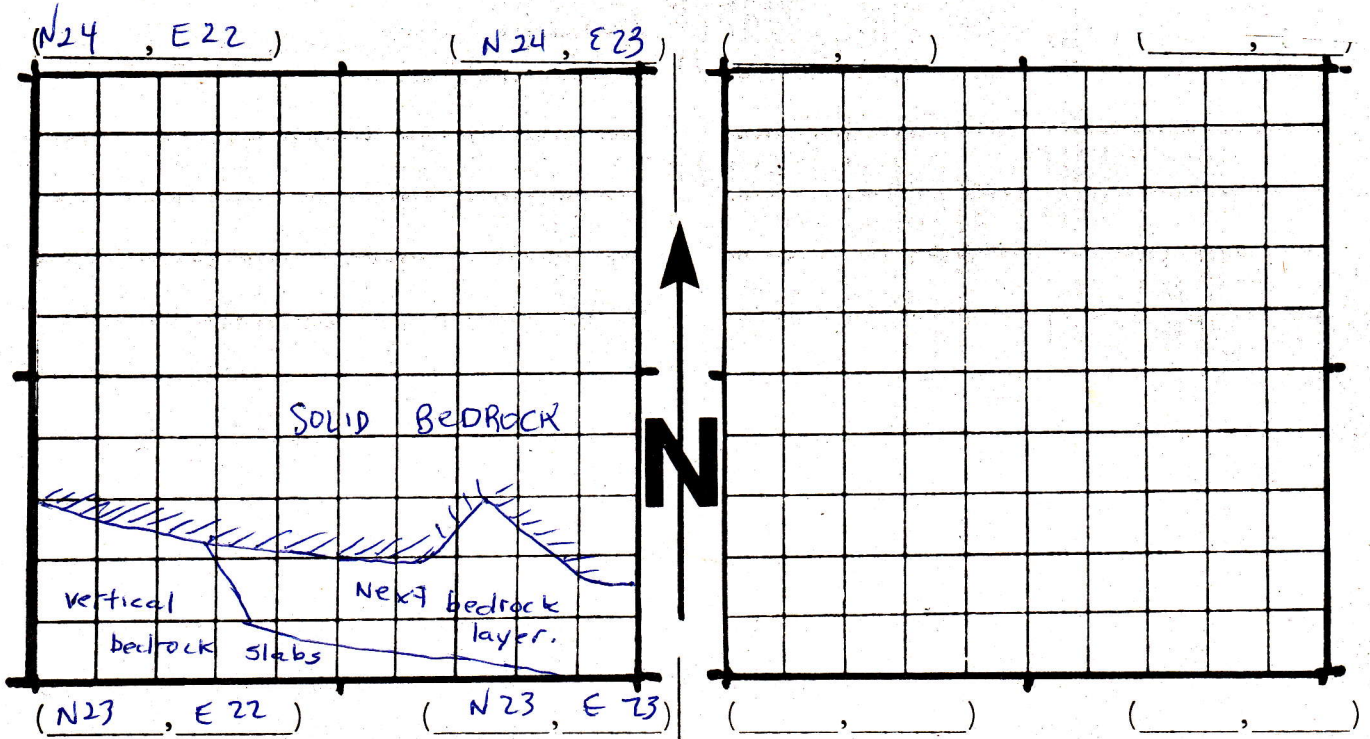

Level No.: _____

Level No.: _____

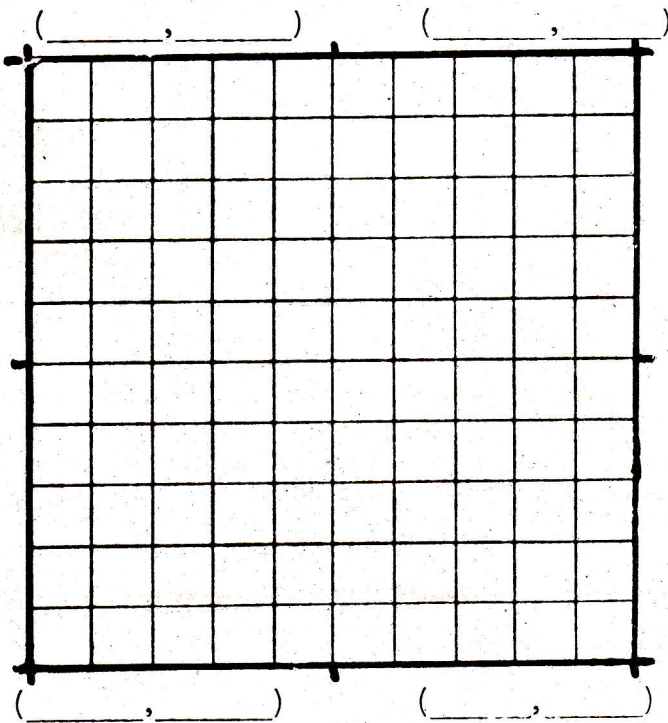

Level No.: _____

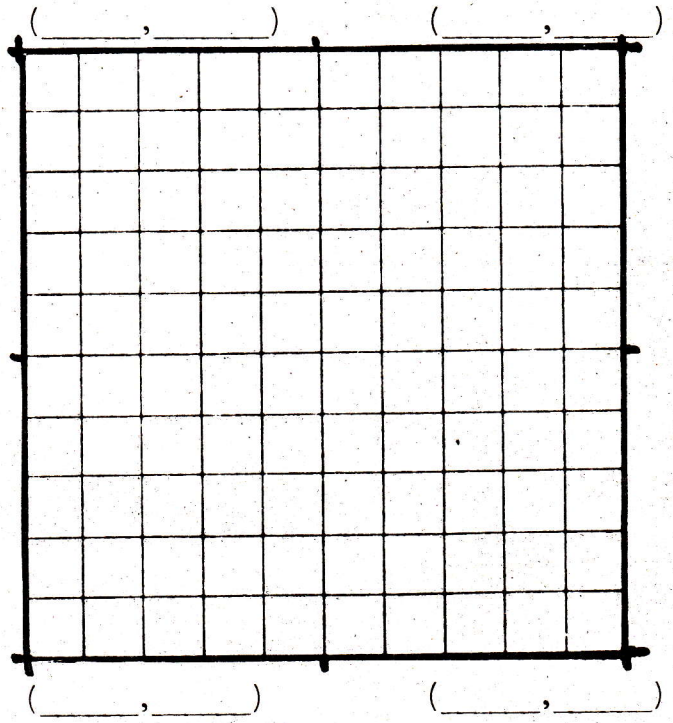

Level No.: _____

I = 10 cm.

FLOOR PLAN FORM

Site No.: HBRf 39 JULY 13/91 (41)

- 1. Excavation Unit: 23 N 22-23 E 20-21
- 2. Level Nos.: 77-1
- 3. Excavators: HANDY
- 4. Comments:

21
31
26

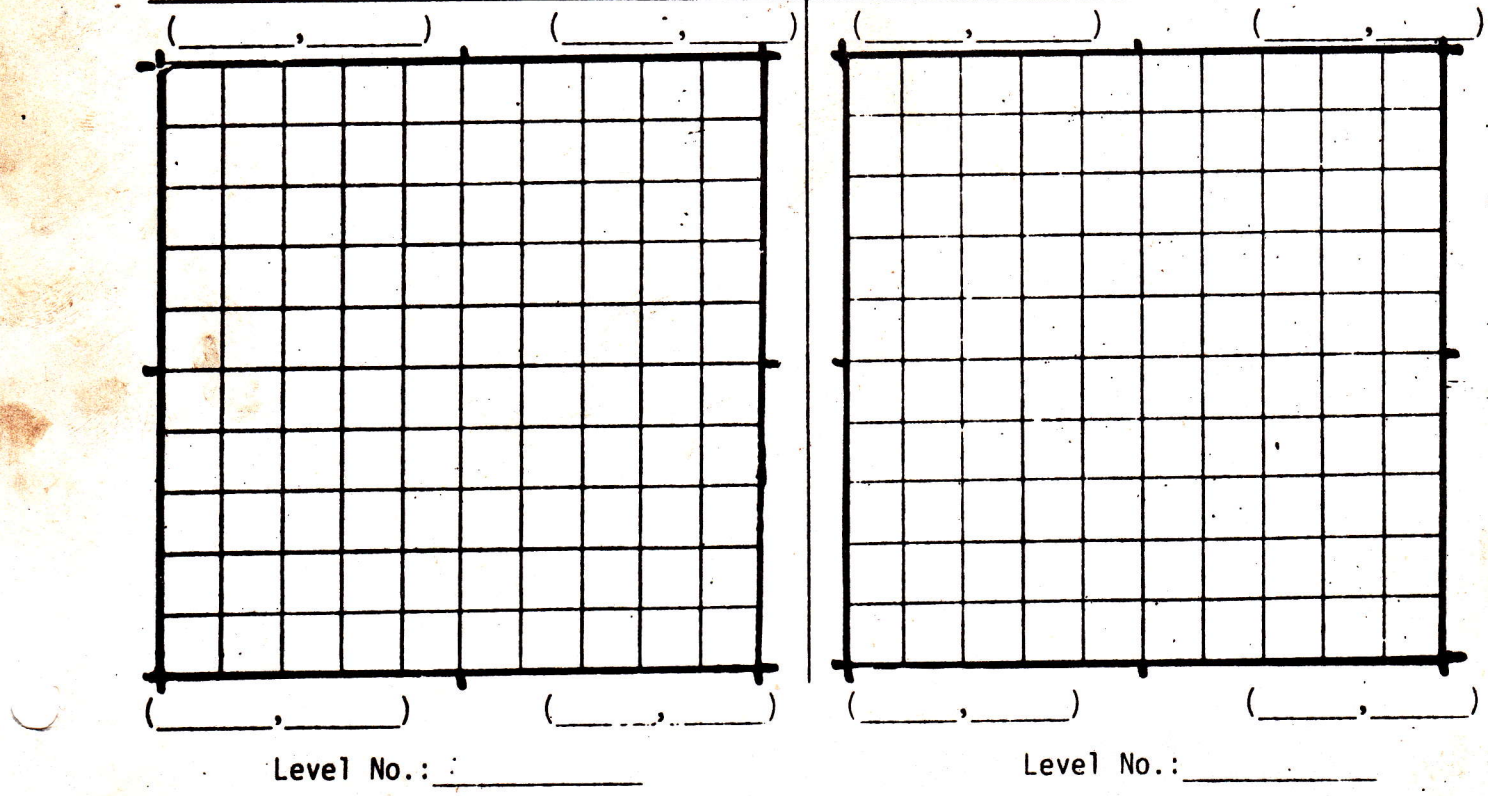
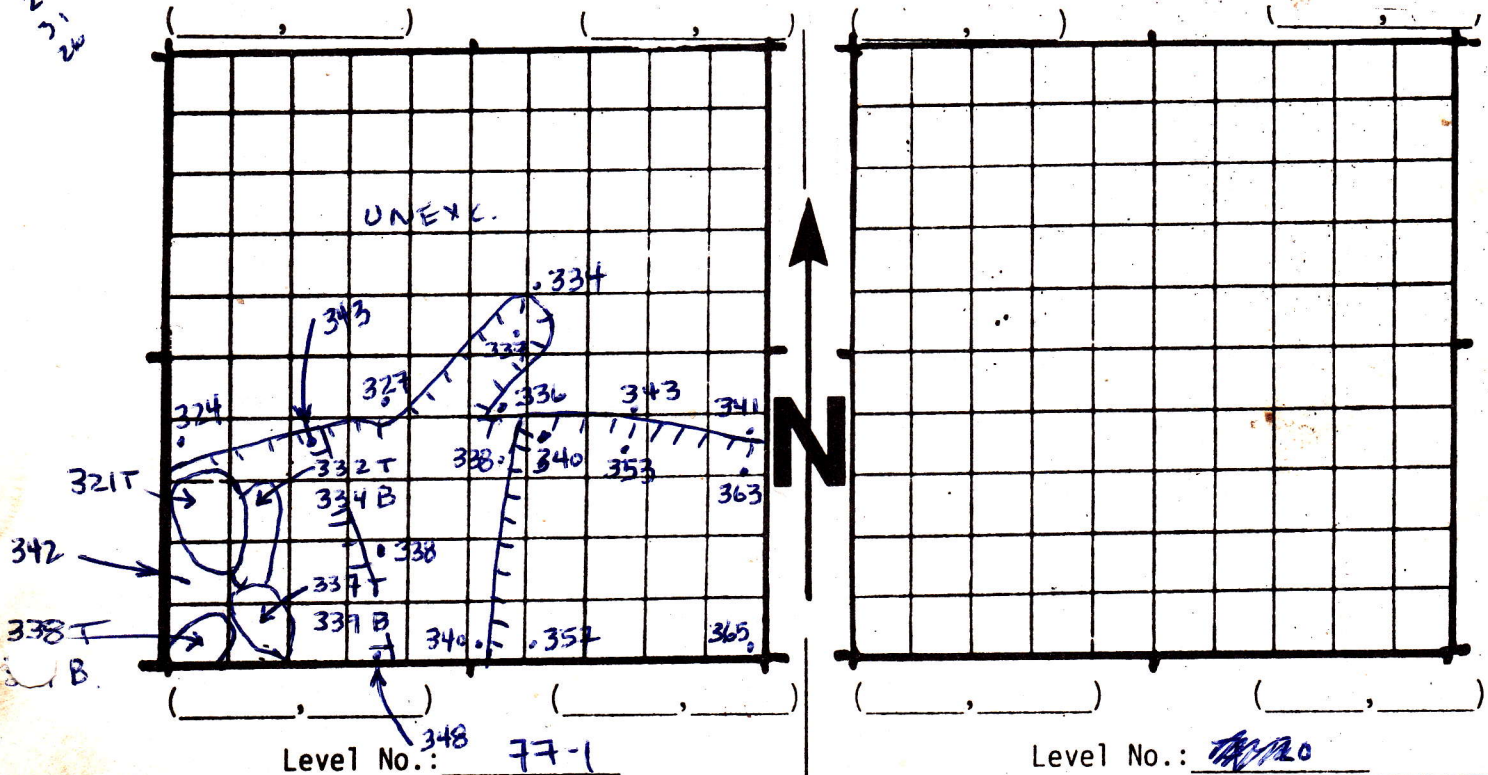

10 = 10 cm.

1. Excavation Unit: 23 N22-23, E20-21

2. Level Nos.: 93-1 3. Excavators: HANDLY

4. Comments: *W. SW corner platy sandst. frags.*

*30, 31 BW
17, 18 col.*

Thick
1 4 cm
2 5 cm
3 5 cm
4 4 cm
5 5 cm
6 5 cm
7 4 cm

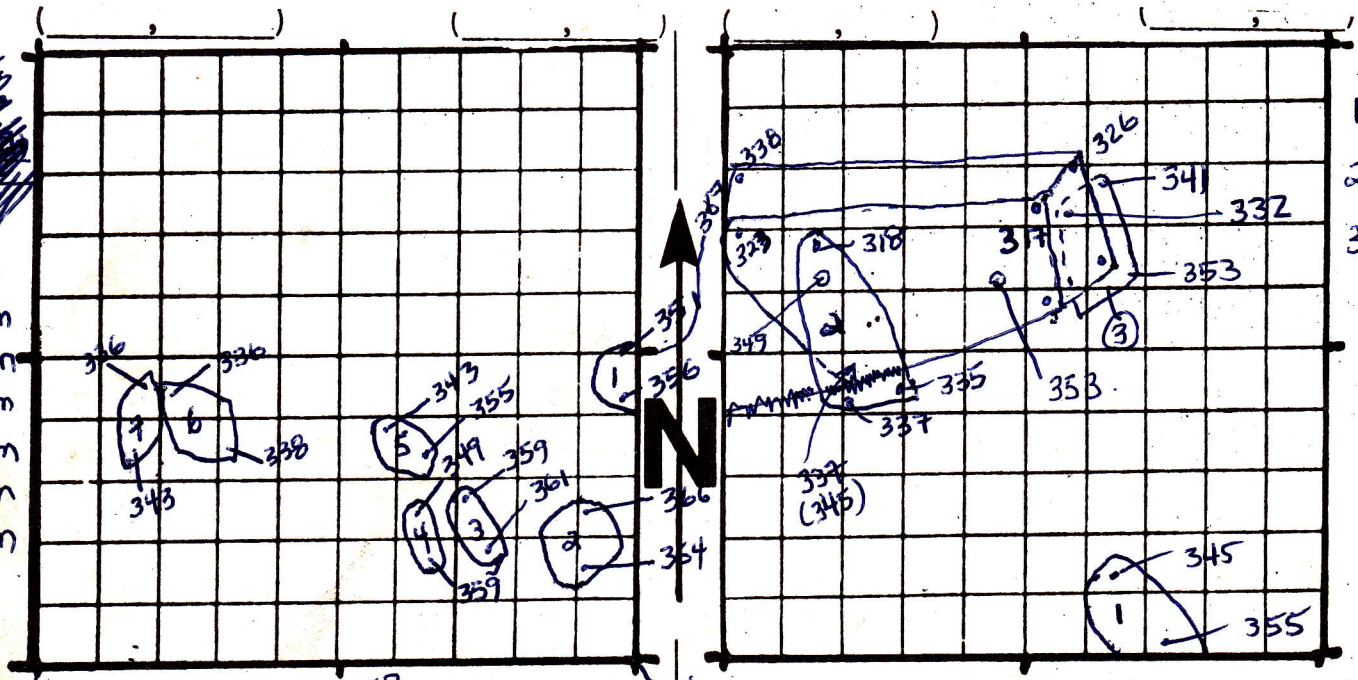

1 5cm
2 6cm
3 4cm

Level No.: 93-1 Level No.: 93-1 (lower)

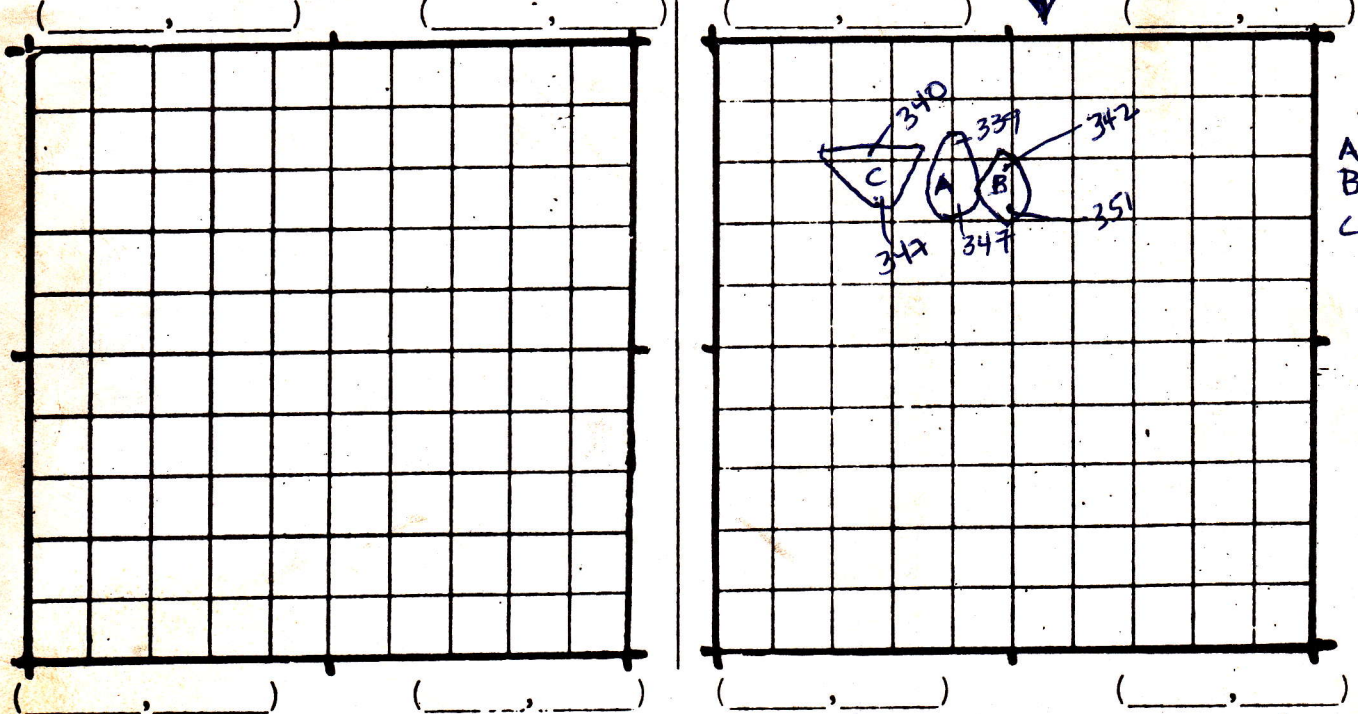

A 3cm
B 3cm
C 3cm

Level No.: 93-1

= 10 cm.

23 July '91

1. Excavation Unit: 23 N22-23, E20-21

2. Level Nos.: 93-2

3. Excavators: MANLY

4. Comments:

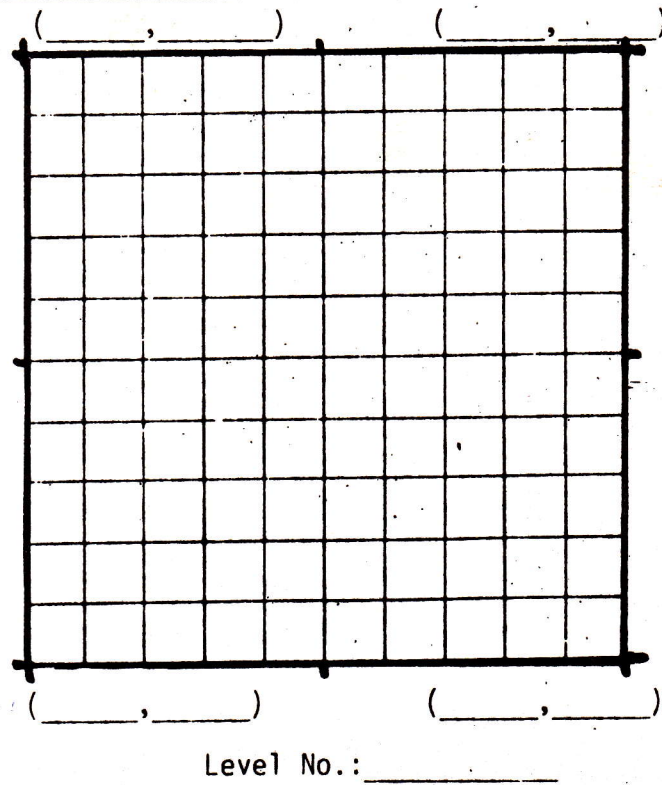
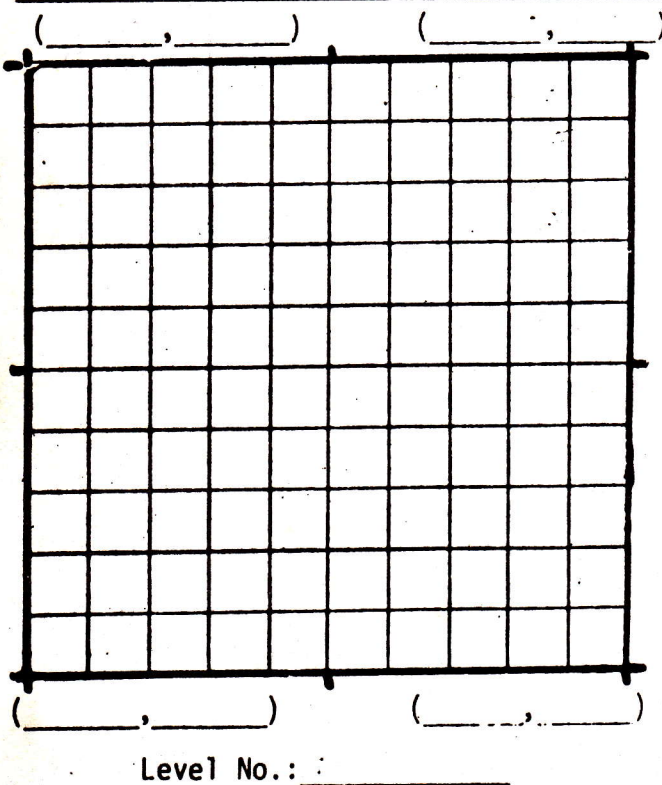
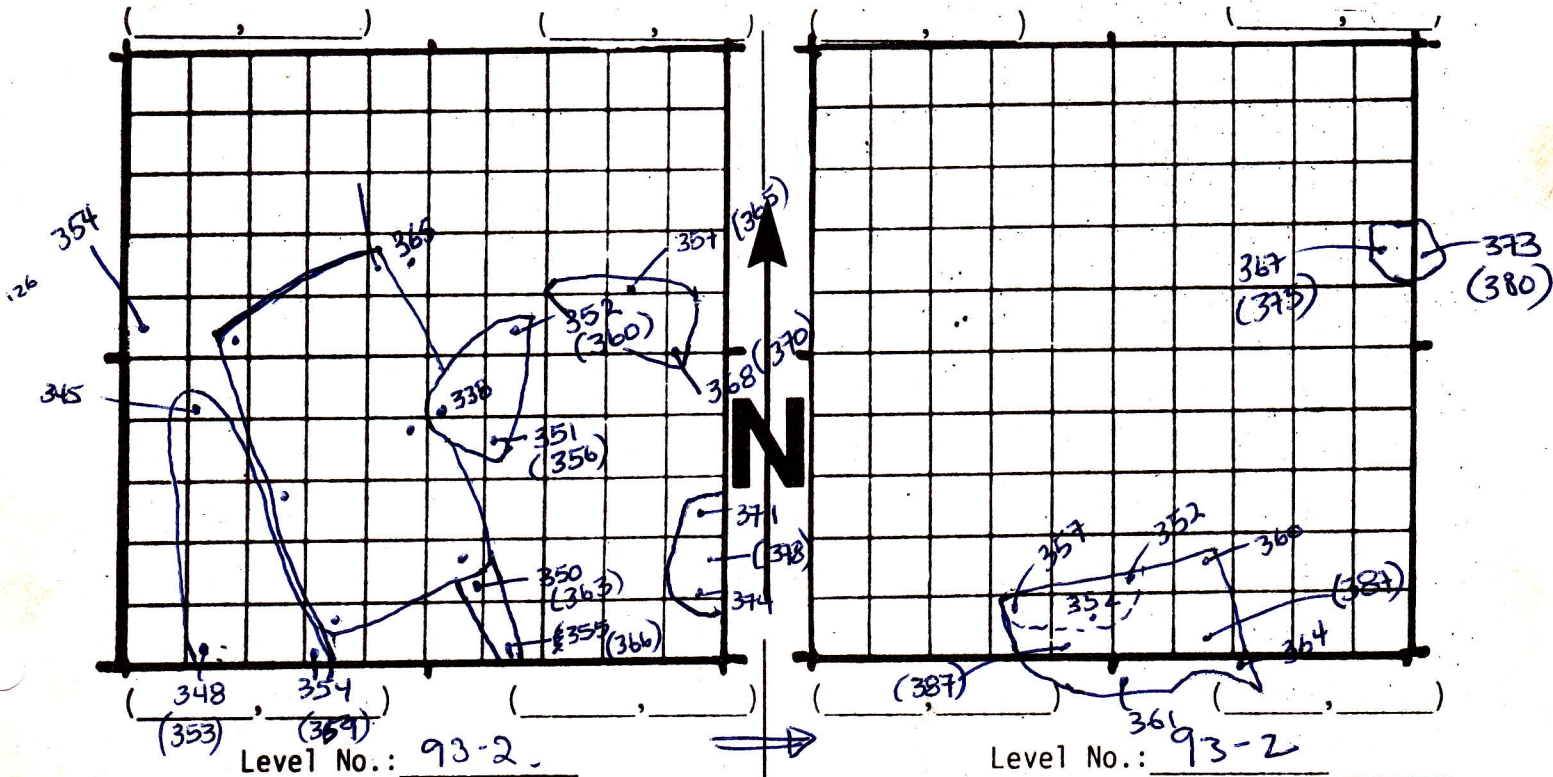

I = 10 cm.

- 1. Excavation Unit: 23 N22-23, E20-21
- 2. Level Nos.: 93-3 3. Excavators: 209
- 4. Comments:

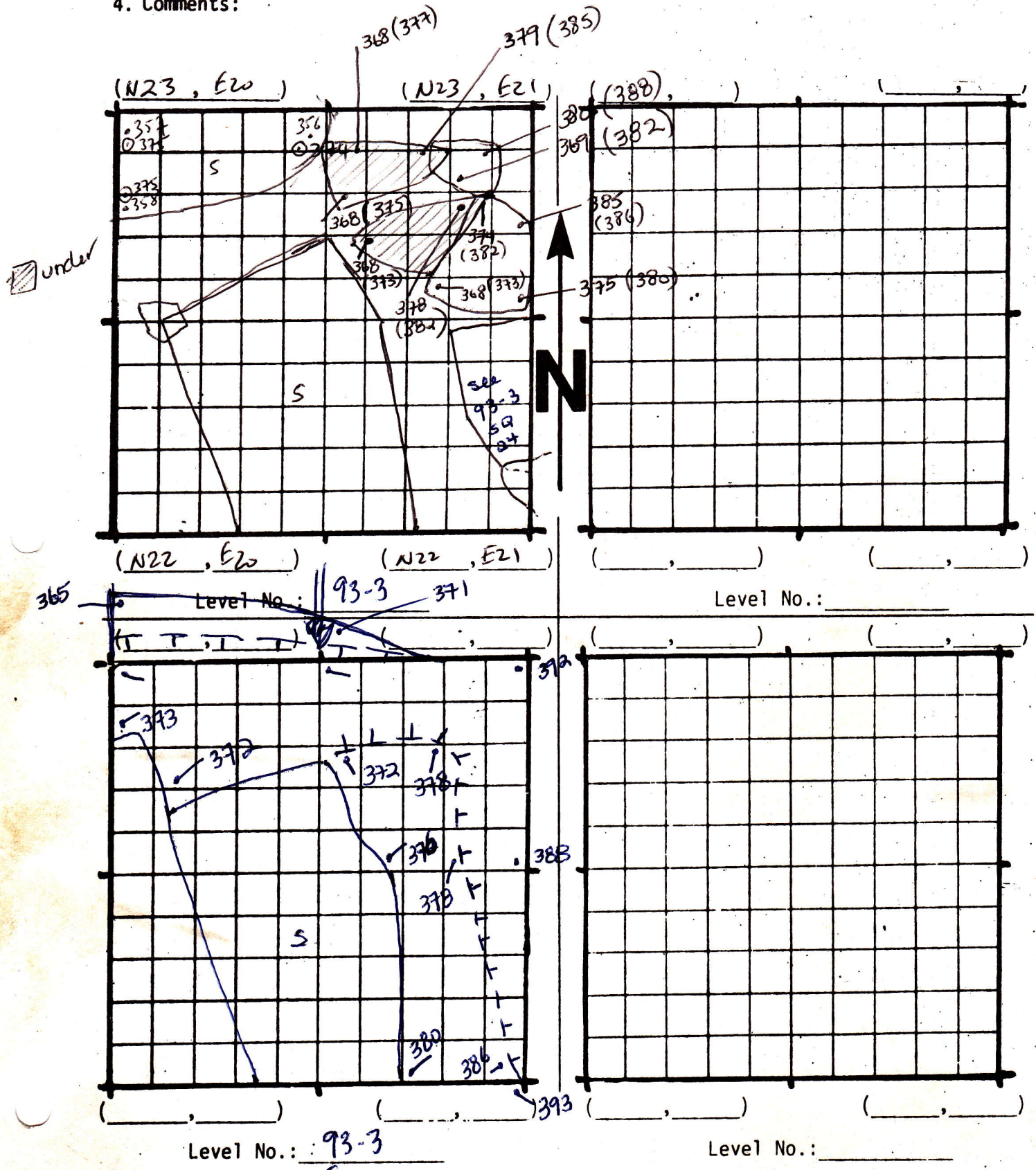

Level No.: 93-3

Level No.:

(part 2)

10 = 10 cm.

1. Excavation Unit: 23 N22-23 E20-21

2. Level Nos.: 98-2 3. Excavators: GMS

4. Comments:

A LARGER BOND +
N22-75 QUARTER
E20-50 FLACK?
DBD = 391 (TOP)

TOP 377 379
(N23, E20) | BOTTOM = +9.0m

317
24
391

317
51
797

317
68
65

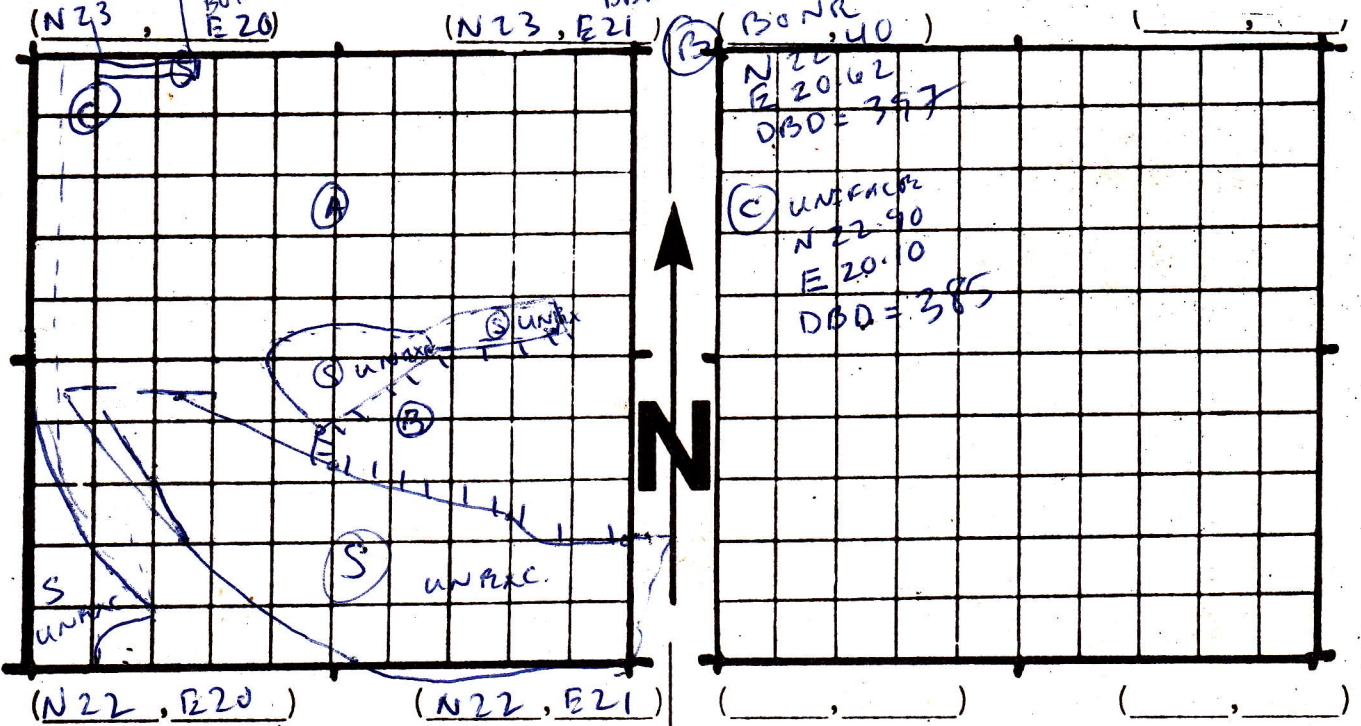

(N22, E20) (N22, E21) (,) (,)

Level No.: 98-2

Level No.: _____

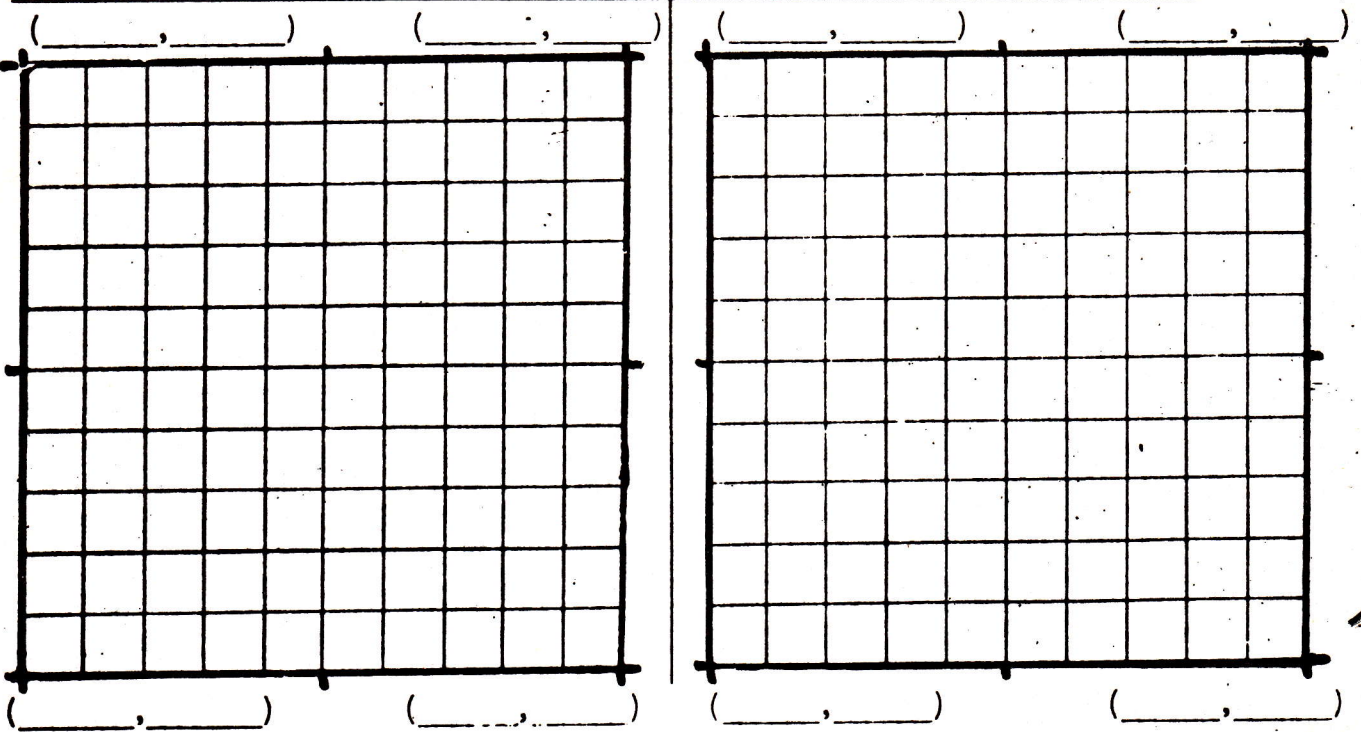

Level No.: _____

Level No.: _____

H = 10 cm.

1. Excavation Unit: 23 N22-23 E20-21

2. Level Nos.: 98-3

3. Excavators: _____

4. Comments:

Bedrock

bedrock at base of level

⊙ = dark grey brown clay not excavated.

○ = top
⊙ = base
▲ = base of 98-3

98-3

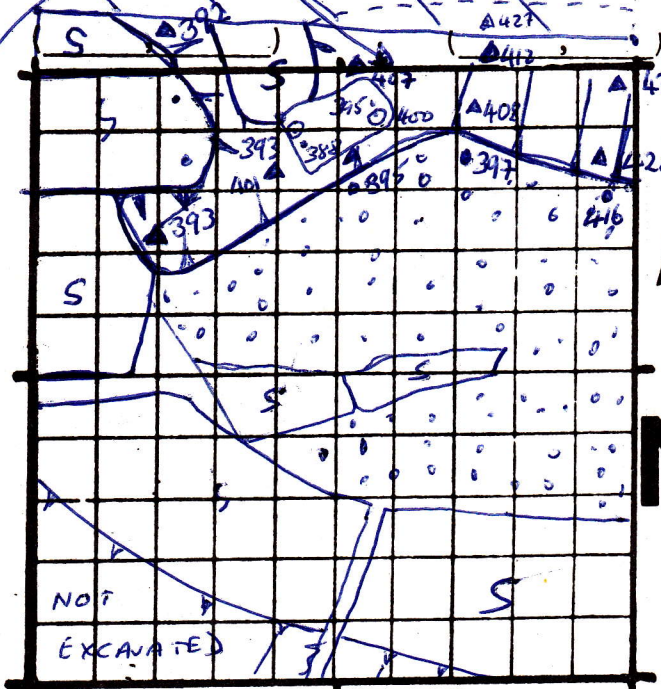

(N22, E20)

(N22, E21)

Level No.: 98-3

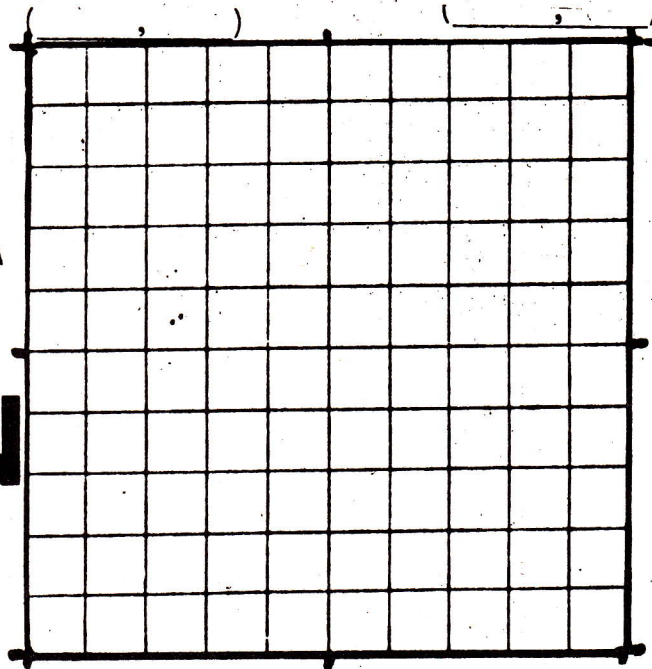

Level No.: _____

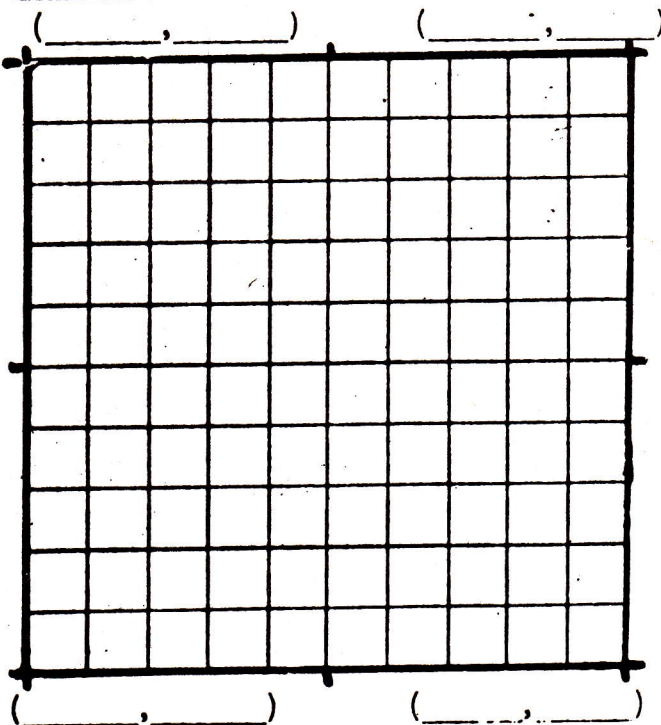

Level No.: _____

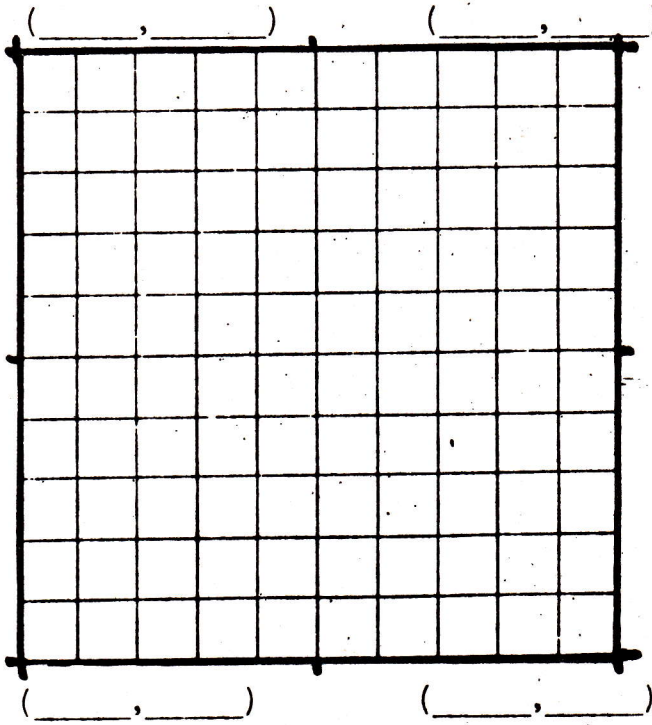

Level No.: _____

10 cm.

1. Excavation Unit: 23 N22-23 E20-21

2. Level Nos.: 102-1, 3. Excavators: GMS

4. Comments: (S) = SANDSTONE ROCK UNEXCAV. THIS LEVEL (N) = NON SANDSTONE ROCK (X) TOP DBD (O) BOTTOM DBD

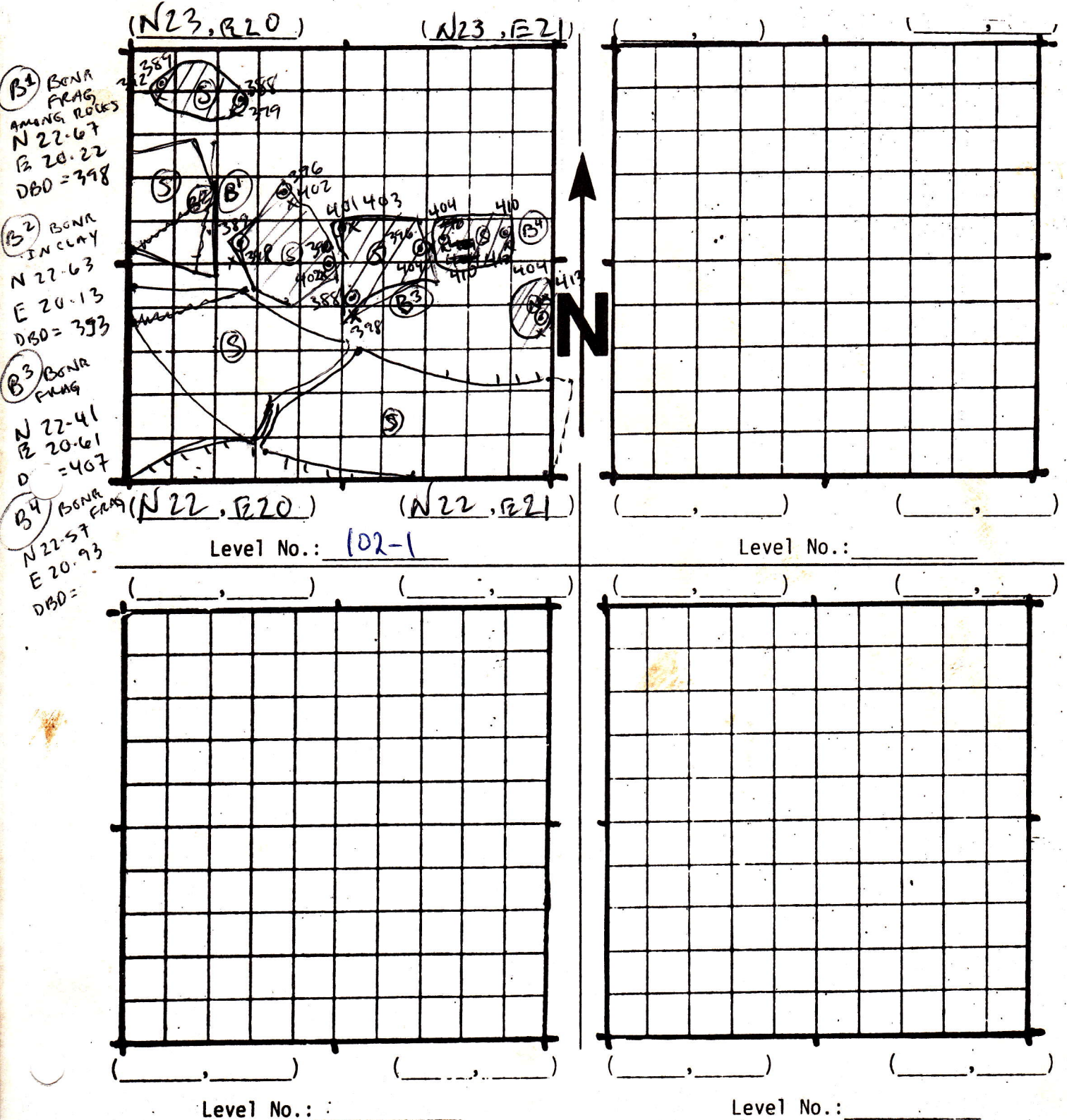

B1 BONR FRAG AMONG ROCKS N 22-67 E 20-22 DBD = 398

B2 BONR IN CLAY N 22-63 E 20-13 DBD = 393

B3 BONR FRAG N 22-41 E 20-61 DBD = 407

B4 BONR FRAG N 22-57 E 20-93 DBD =

I = 10 cm.

79 372 385
 717 87044 76
 87 372 410

317 79 396
 8471
 317 7170 388

1. Excavation Unit: 23 N22-23 E20-21

2. Level Nos.: 102-2

3. Excavators: RPP

4. Comments:

426
-58
368

22
17
399

20cm
58

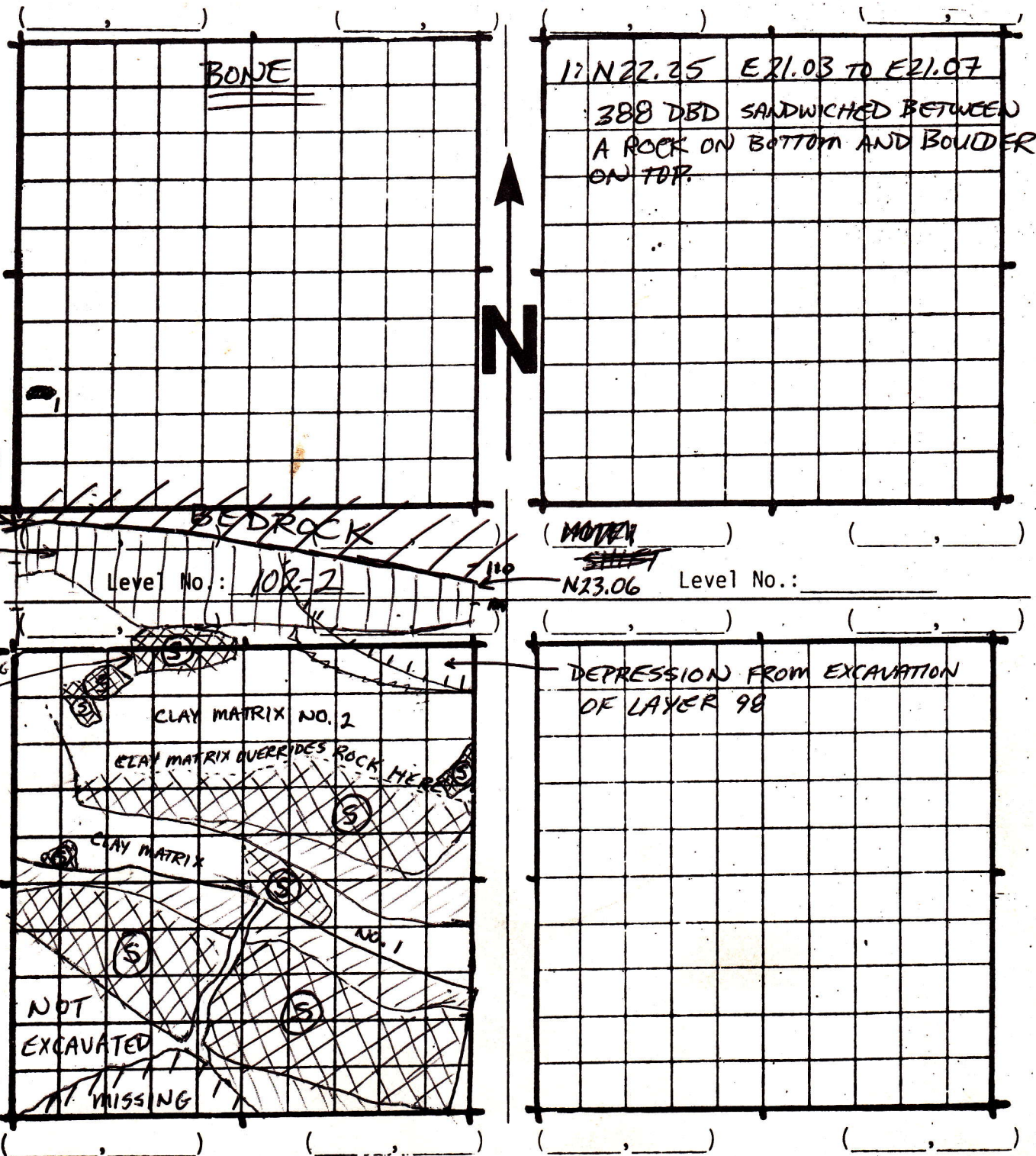

Level No.: 102-2

Level No.: _____

BASE OF LAYER 102-2 = 10 cm.