

Unit 4 1991

105-1

105-2

105-3

LEVEL RECORD FORM

Site No.: Hbrf 39

- 1. Excavation unit: 4 (1983 UNIT)
- 2. Level No.: 105-1
- 3. Excavated by: HANDLY / DRIVER
- 4. Date: AUG 16/91

Definition of Level:

- 5. Upper surface of level was (a layer boundary; contoured arbitrary; horizontal arbitrary): \_\_\_\_\_
- 6. Floor of level is (a layer boundary; contoured arbitrary; horizontal arbitrary): POSS. LAYER BDRY. IN NW QUAD. (LAYER 107?)
- 7. Thickness of level: NW: /; NE: /; SW: 10; SE: 10
- 8. Indicate DBD and DBS for each of the marked points, on the lefthand diagram below:

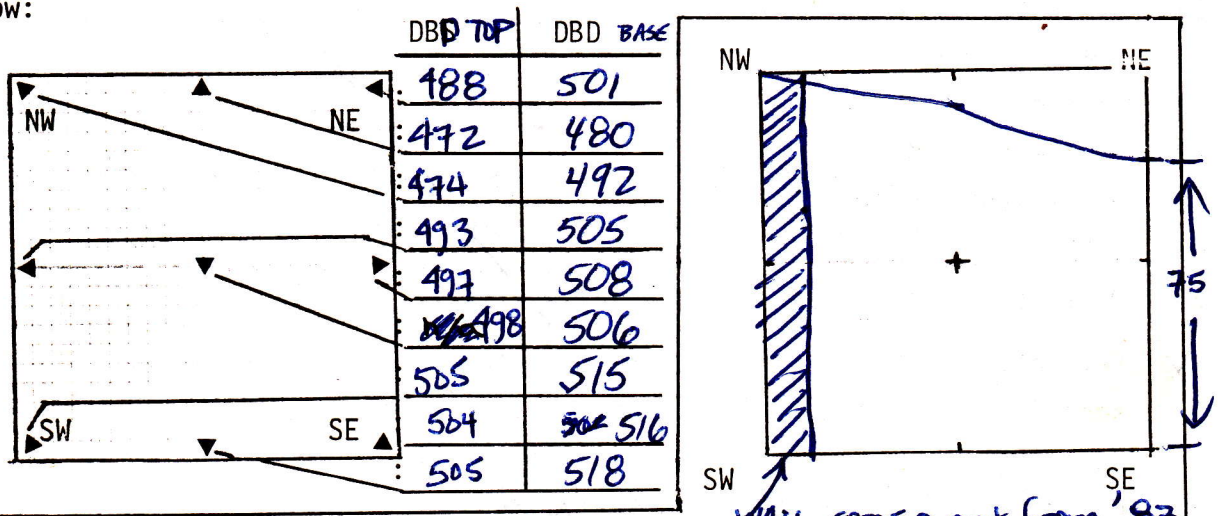

- 9. Indicate on the righthand diagram above, the horizontal boundaries of this level, if not encompassing entire unit: wet
- 10. Depth of unit datum below site datum: 472
- 11. Munsell colour: 2.5Y 4/4
- 12. General description of matrix: moderately to fairly compact clayey silt, slightly sticky, slightly plastic. Dry @ excavation.
- 13. Any variations from basic layer characteristics: NO
- 14. Evidence of any disturbance or intrusion: NO
- 15. Matrix sample(s) collected: NONE.



LEVEL RECORD FORM (Contd.)

Specific Content Description: (based on screen contents)

	NE	NW	SE	SW	Tot.
16. Historic items (no.):					0
17. Modified artifacts: (no.):					0
18. Black chert flakes (no.):					0
19. Other flakes (no.):					0
20. Alloch. unmodified stones (no./wt.):					✓
21. Alloch. heat-altered stones (wt.):					0
22. Heat altered sandstone (wt.):					0
23. Unaltered eboulis (wt.)					✓
24. Large mammal bones (no./wt.):					✓
25. Small mammal/bird bones (wt.):					✓
26. Fish bones (no./wt.):					0
27. Shells (no./wt.)					0
28. Plant remains (no.):					0
29. Other ( )::					1
30. Other ( )::					1

31. Percentage charcoal ( ); ash ( ); humus ( ); sandstone eboulis ( ); sand ( ); silt ( ); clay ( ), if different from general layer description. Same as general layer description: \_\_\_\_\_.

32. Description of cultural features: N/A

---



---

33. Description of notable artifacts: N/A

---

34. Comments on other cultural contents: N/A

---

35. Characteristics of sandstone eboulis: Dimensions largest frag.: \_\_\_\_\_  
 Estimated average dimensions: N/A; Rounding/angularity: \_\_\_\_\_  
 General dip and orientation, if any: \_\_\_\_\_ / \_\_\_\_\_  
 Other characteristics: \_\_\_\_\_

36. Charcoal samples: NONE

37. Photos: NONE 38. Drawing: (yes) (no) 39. Screen size: 1/8 INCH

40. Other comments and description on additional pages: (yes) (no).

APPEAR TO HAVE REACHED RUBBLY MATRIX (LAYER 107?) IN NW QUAD.

LEVEL RECORD FORM

Site No.: Hbrf 39

- 1. Excavation unit: 4 (1983 UNIT)
- 2. Level No.: 105-2
- 3. Excavated by: HANDLY/PRESTON
- 4. Date: 16 AUG 91

Definition of Level:

- 5. Upper surface of level was (a layer boundary, countoured arbitrary; horizontal arbitrary): POSS. LAYER BDRY IN NW QUAD (LAYER 107?)
- 6. Floor of level is (a layer boundary, contoured arbitrary; horizontal arbitrary): \_\_\_\_\_
- 7. Thickness of level: NW: 4cm; NE: 3cm; SW: 7cm; SE: 14cm
- 8. Indicate DBD and DBS for each of the marked points, on the lefthand diagram below:

	DBS	DBD cm
▲	501	504
▲	480	487
▲	492	496
▲	505	513
▲	508	517
▲	<del>506</del>	514
▲	515	523
▲	516	530
▲	518	526

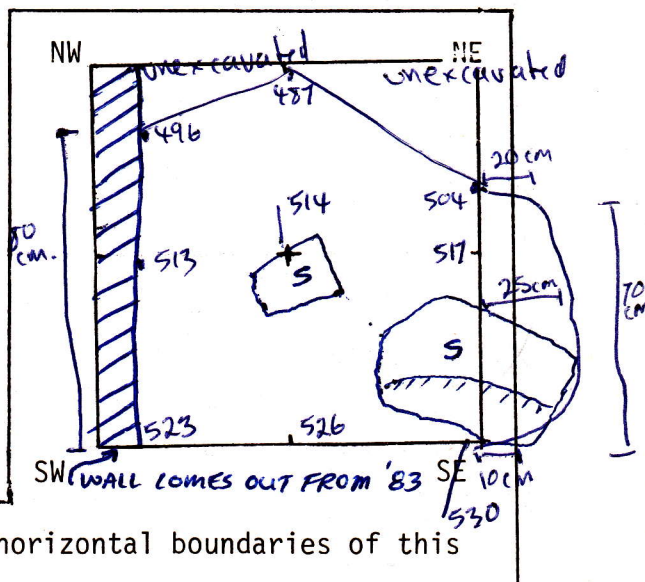

- 9. Indicate on the righthand diagram above, the horizontal boundaries of this level, if not encompassing entire unit:
- 10. Depth of unit datum below site datum: 472
- 11. Munsell colour: WET: 2.5Y 4/4
- 12. General description of matrix: MODERATELY TO FAIRLY COMPACT CLAYEY SILT, SLIGHTLY STICKY, SLIGHTLY PLASTIC. MOIST @ EXCAVATION

13. Any variations from basic layer characteristics: NONE NOTED. As excavation progressed, noted presence of reddish ferrous material throughout matrix.

14. Evidence of any disturbance or intrusion: ROOTS

15. Matrix sample(s) collected: YES, ONE



LEVEL RECORD FORM (Contd.)

Specific Content Description: (based on screen contents)

	NE	NW	SE	SW	Tot.
16. Historic items (no.):					0
17. Modified artifacts: (no.):					✓
18. Black chert flakes (no.):					✓ flake ✓ tool-one
19. Other flakes (no.):					✓ quartzite ✓ flake-one
20. Alloch. unmodified stones (no./wt.):					✓
21. Alloch. heat-altered stones (wt.):					0
22. Heat altered sandstone (wt.):					0
23. Unaltered ebbulis (wt.)					✓
24. Large mammal bones (no./wt.):					✓
25. Small mammal/bird bones (wt.):					✓
26. Fish bones (no./wt.):					0
27. Shells (no./wt.)					0
28. Plant remains (no.):					0
29. Other ( ):					0
30. Other ( ):					0

31. Percentage charcoal ( ); ash ( ); humus ( ); sandstone ebbulis ( ); sand ( ); silt ( ); clay ( ), if different from general layer description. Same as general layer description: \_\_\_\_\_.

32. Description of cultural features: none

33. Description of notable artifacts: see plan views and level pages

34. Comments on other cultural contents: none

35. Characteristics of sandstone ebbulis: Dimensions largest frag.: 50 x 33 cm approx  
 Estimated average dimensions: \_\_\_\_\_; Rounding/angularity: \_\_\_\_\_  
 General dip and orientation, if any: \_\_\_\_\_/  
 Other characteristics: \_\_\_\_\_

36. Charcoal samples: no

37. Photos: no 38. Drawing: (yes)(no) 39. Screen size: 1/8 INCH

40. Other comments and description on additional pages:(yes)(no).

LEVEL RECORD FORM

Site No.: HBRf 39

- 1. Excavation unit: 4
- 2. Level No.: 105-3
- 3. Excavated by: MT H
- 4. Date: Aug 17/91

Definition of Level:

- 5. Upper surface of level was (a layer boundary; countoured arbitrary; horizontal arbitrary):
- 6. Floor of level is (a layer boundary; contoured arbitrary; horizontal arbitrary):
- 7. Thickness of level: NW: 12 cm; NE: 4 cm; SW: 14 cm; SE: 19 cm.
- 8. Indicate DBD and DBS for each of the marked points, on the lefthand diagram below:

	DBS cm	DBD
NW	504	508
NE	487	498
	496	508
	513	523
	517	515?
	<del>514</del>	524
	523	537
SW	530	549
SE	526	538

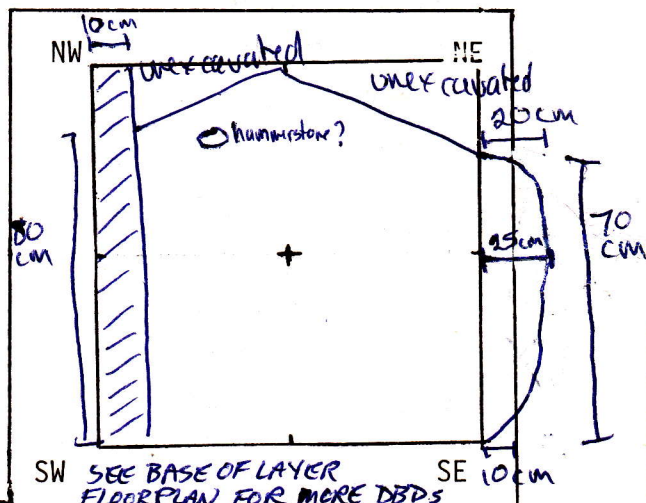

- 9. Indicate on the righthand diagram above, the horizontal boundaries of this level, if not encompassing entire unit:
- 10. Depth of unit datum below site datum: 472 cm.
- 11. Munsell colour: see 105-1
- 12. General description of matrix: see 105-1

13. Any variations from basic layer characteristics: More weathered sandstone than in preceding levels.

14. Evidence of any disturbance or intrusion: SMALL ROOTS

15. Matrix sample(s) collected: no



LEVEL RECORD FORM (Contd.)

Specific Content Description: (based on screen contents)

	NE	NW	SE	SW	Tot.
16. Historic items (no.):					0
17. Modified artifacts: (no.):					1 POSS. HAMMER-STONE
18. Black chert flakes (no.):					0
19. Other flakes (no.):					0
20. Alloch. unmodified stones (no./wt.):					✓
21. Alloch. heat-altered stones (wt.):					0
22. Heat altered sandstone (wt.):					0
23. Unaltered eboulis (wt.)					✓
24. Large mammal bones (no./wt.):					2 A FEW FRAGS
25. Small mammal/bird bones (wt.):					
26. Fish bones (no./wt.):					0
27. Shells (no./wt.)					0
28. Plant remains (no.):					0
29. Other ( )::					-
30. Other ( )::					-

~~31.~~ Percentage charcoal ( ); ash ( ); humus ( ); sandstone eboulis ( ); sand ( ); silt ( ); clay ( ), if different from general layer description. Same as general layer description: \_\_\_\_\_.

32. Description of cultural features: N/A

33. Description of notable artifacts: N/A

34. Comments on other cultural contents: N/A

35. Characteristics of sandstone eboulis: Dimensions largest frag.: ?  
Estimated average dimensions: /; Rounding/angularity: ANGULAR TO SUBANGULAR  
General dip and orientation, if any: W/ THE MATRIX /  
Other characteristics: /

36. Charcoal samples: NONE

37. Photos: NONE 38. Drawing: (yes)(no) 39. Screen size: 1/8 INCH

40. Other comments and description on additional pages: (yes)(no). SEE FLOOR PLANS